

The different Courses
down the River & the Gut
from the Elm to the
Locust.

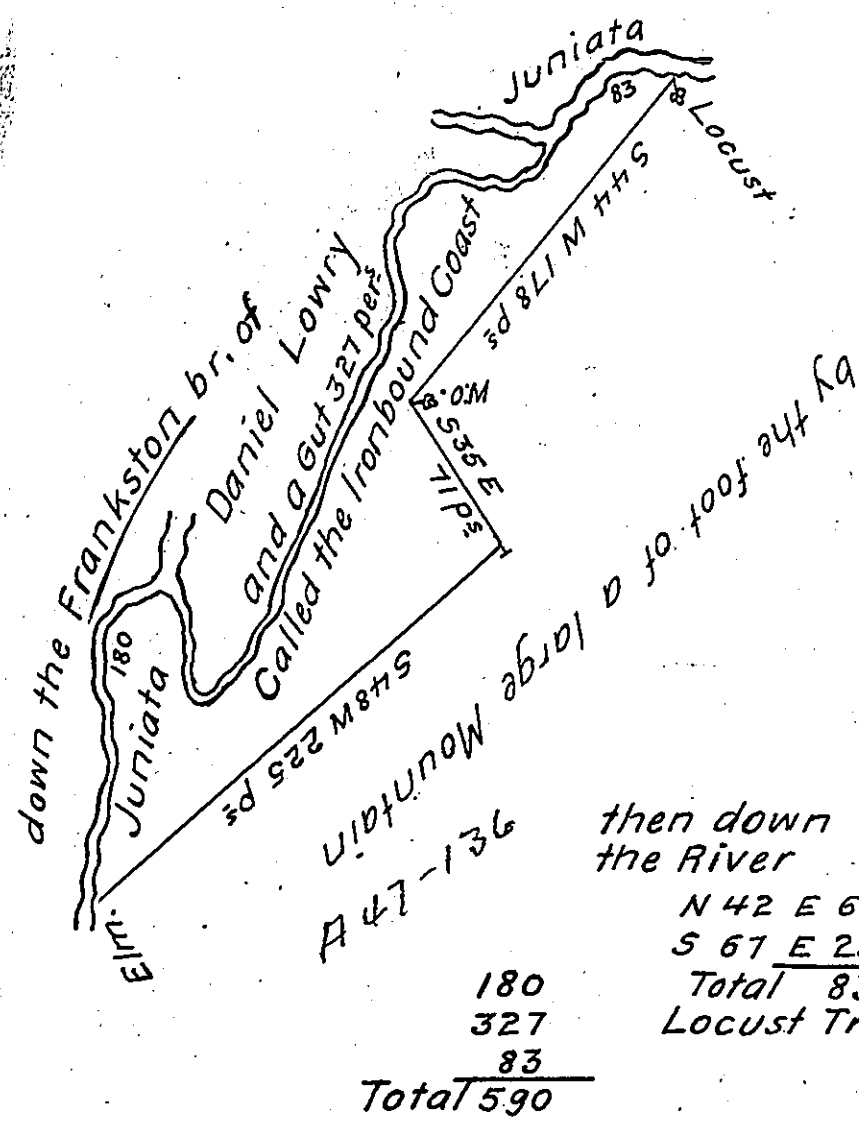

N 10 E 58.
N 20 W 28.
N 18 E 30.
N 65 E 18.
S 17 E 14.
S 9 E 32
Total 180. to the
head of the Island
thence by Daniel
Lowrys Land..

N 51 E 20.
N 29 E 102.
N 13 E 30.
N 38 E 28.
N 16 E 22.
N 25 W 23.
N 35 E 34.
S 85 E 30.
S 47 E 18.
N 20 E 20.
327 to the
River

In pursuance of an order No. 227. dated the first day of
August 1766, I have Surveyed for James Hunter the above desc-
ribed Tract of Land situate on the Southerly side of the Frankstown
branch of Juniata River in the County of Cumberland containing
one hundred and forty eight Acres and three quarters and the
usual allowance of six acres & Ct. for Roads & ca. ~

Richard Tea Depy. Surveyr.

To John Lukens Esq.
Surveyor General ~

IN TESTIMONY that the above is a copy of the original remaining on file in
the Department of Internal Affairs of Pennsylvania, made
conformably to an Act of Assembly approved the 16th day of
February, 1833, I have hereunto set my Hand and caused
the Seal of said Department to be affixed at Harrisburg,
this twenty-fourth day of March 1905 ~

James D. [Signature]
Secretary of Internal Affairs.